

Cim RED6/1

FULL BORE BALL VALVE - RED 5 SERIES - ALUMINIUM BUTTERFLY HANDLE



This article was made in compliance with the quality management requirements of ISO 9001 standard. All articles are tested according to the EN 12266-1 standard.

It can be used in a wide variety of sectors: heating, air conditioning, water, sanitary systems, pneumatic systems, oil pipelines, gasoline networks, saturated steam and generally with any non corrosive liquid.

It is guaranteed for 5 years.

It is made of a brass alloy that complies with standard EN 12165-CW617N-M.

Nominal Pressure:

PN 50 (1/2"); PN 40 (3/4" ÷ 1"); PN 30 (1"1/4 ÷ 1"1/2); PN 25 (2")

Operating temperature: -20 ÷ 150°C

FLOW AND PRESSURE DROP

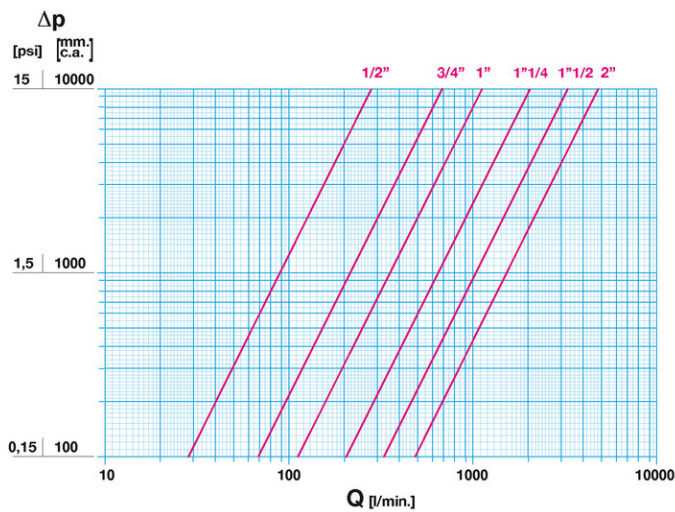

Notes:

- 1 l/min = 0,06 m³/h
- 1 m³/h = 16,67 l/min
- 1 bar = 10.000 mm w.c.
- 1 psi = 690 mm w.c.

PRESSURE TEMPERATURE RATINGS

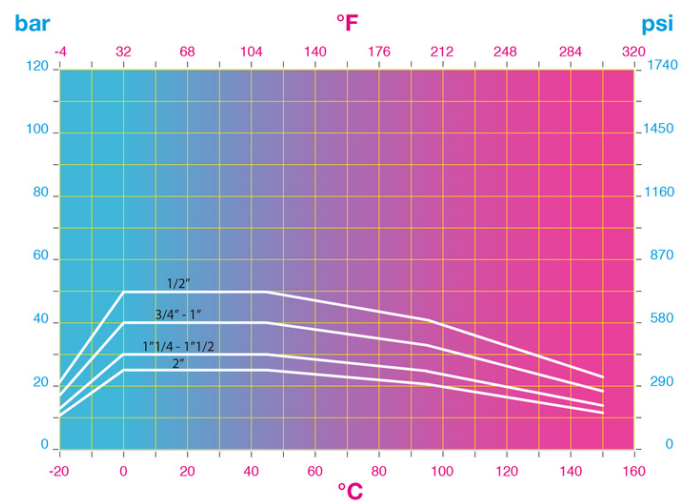

Notes:

- 1 bar = 14,5 psi
- 1 bar = 14,5 lbf/in²
- °C = 5/9 x (°F-32)
- °F = 32 + (9/5 x °C)

TECHNICAL DRAWING

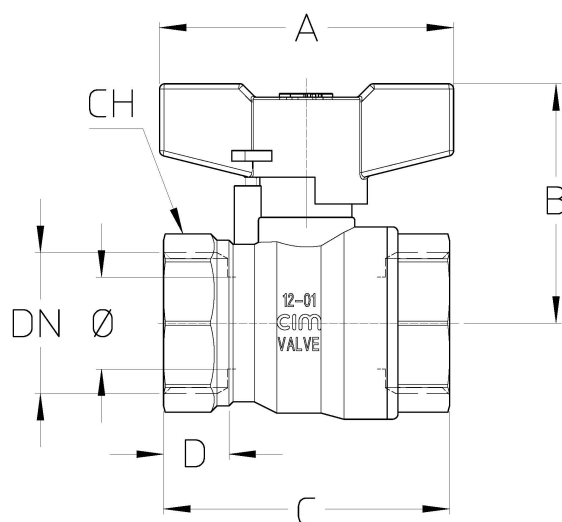

| | | | | | | |
|--------------|------------|------------|------------|------------|------------|-------------|
| DN | 1/2" | 3/4" | 1" | 1"1/4 | 1"1/2 | 2" |
| Ø mm | 14 | 19 | 24 | 29 | 37 | 47 |
| Grms. | 145 | 235 | 350 | 475 | 815 | 1240 |
| A | 55 | 55 | 75 | 75 | 105 | 105 |
| B | 39 | 43,5 | 48 | 53 | 68 | 74 |
| C | 47 | 53,5 | 66 | 74 | 88 | 102 |
| D | 12 | 12 | 15 | 16 | 18 | 19 |
| CH | 25 | 31 | 37 | 47 | 54 | 66 |

Thread:
ISO 228

Upon request:
ANSI B.1.20.1 - NPT

TECHNICAL CHARACTERISTICS

| KV CM CS MT | | | | | | |
|-------------|------|------|-----|-------|-------|-----|
| DN | 1/2" | 3/4" | 1" | 1"1/4 | 1"1/2 | 2" |
| Ø mm | 14 | 19 | 24 | 29 | 37 | 47 |
| KV | 15 | 37 | 63 | 108 | 179 | 256 |
| CM | 1 | 1,5 | 2,5 | 3 | 8 | 11 |
| CS | 2,5 | 5 | 6 | 10 | 18 | 20 |
| MT | 24 | 24 | 26 | 26 | 88 | 88 |

KV = Capacity in m³/h at pressure drop of 1 bar.

CM = Operating torque in Nm.

CS = Starting torque in Nm.

MT = Stem breaking torque in Nm.

OUR CERTIFICATIONS

