

## Cim 45

### RIGHT ANGLE BALL VALVE - MALE/MALE - PN 16

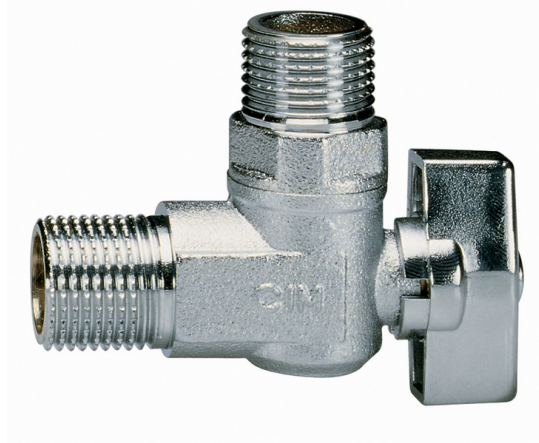

This article was made in compliance with the quality management requirements of ISO 9001 standard. All articles are tested according to the EN 12266-1 standard. It can be used in water and sanitary systems.

It is guaranteed for 5 years.

It is made of a brass alloy that complies with standard EN 12165-CW617N-M.

Nominal Pressure: PN 16

Operating temperature: -15 to 90°C

### FLOW AND PRESSURE DROP

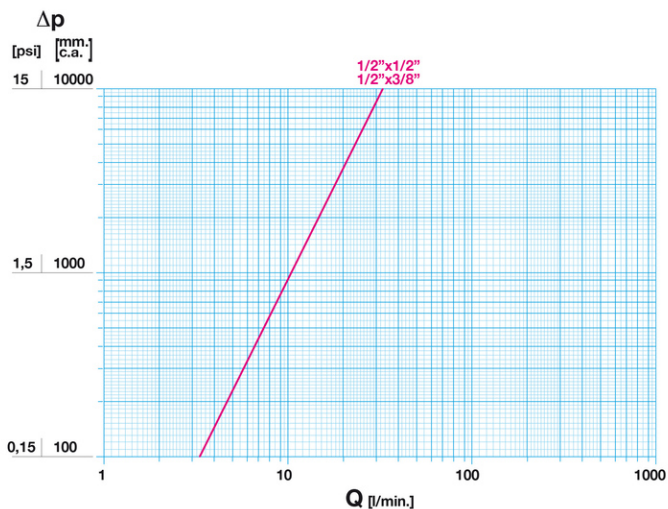

Notes:  
 1 l/min = 0,06 m<sup>3</sup>/h  
 1 m<sup>3</sup>/h = 16,67 l/min  
 1 bar = 10.000 mm w.c.  
 1 psi = 690 mm w.c.

### PRESSURE TEMPERATURE RATINGS

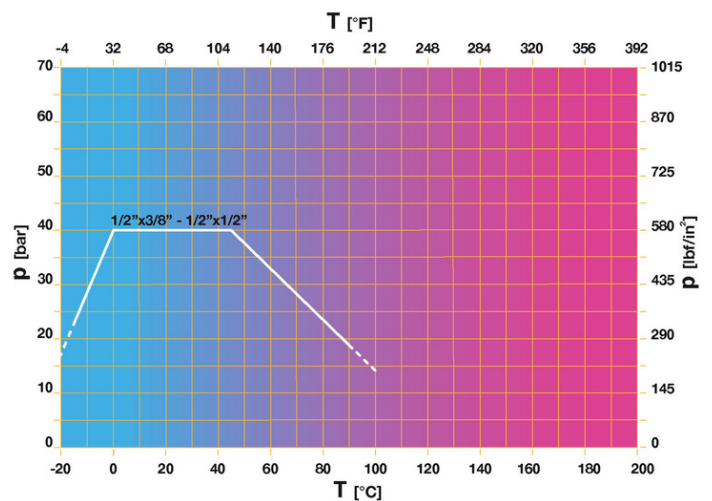

Notes:  
 1 bar = 14,5 psi  
 1 bar = 14,5 lbf/in<sup>2</sup>  
 °C = 5/9 x (°F-32)  
 °F = 32 + (9/5 x °C)

## TECHNICAL DRAWING

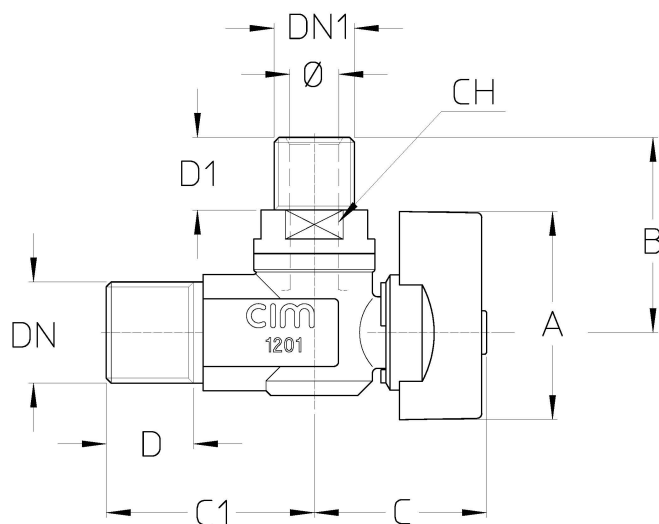

DNxDN1	1/2"x1/2"	1/2"x3/8"
Ø mm	9	9
Grms.	185	189
<b>A</b>	<b>43</b>	<b>43</b>
B	40	40
C	35	35
C1	43	43
D	20	20
D1	15	15
CH	22	22

Thread:  
ISO 228

## TECHNICAL CHARACTERISTICS

KV CM CS MT		
DN1xDN21	1/2"x3/8"	1/2"x1/2"
Ø mm	9	9
KV	2	2
CM	1,5	1,5
CS	2	2
MT	9	9

KV = Capacity in m<sup>3</sup>/h at pressure drop of 1 bar.

CM = Operating torque in Nm.

CS = Starting torque in Nm.

MT = Stem breaking torque in Nm.

## OUR CERTIFICATIONS

