

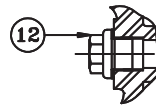

CAST STEEL SWING CHECK VALVES- BS 1868, API-6D, ASME B16.34

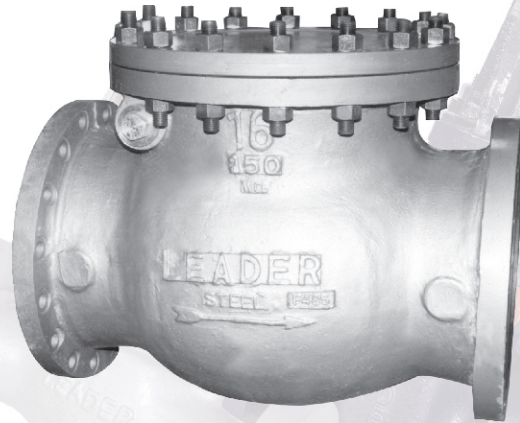
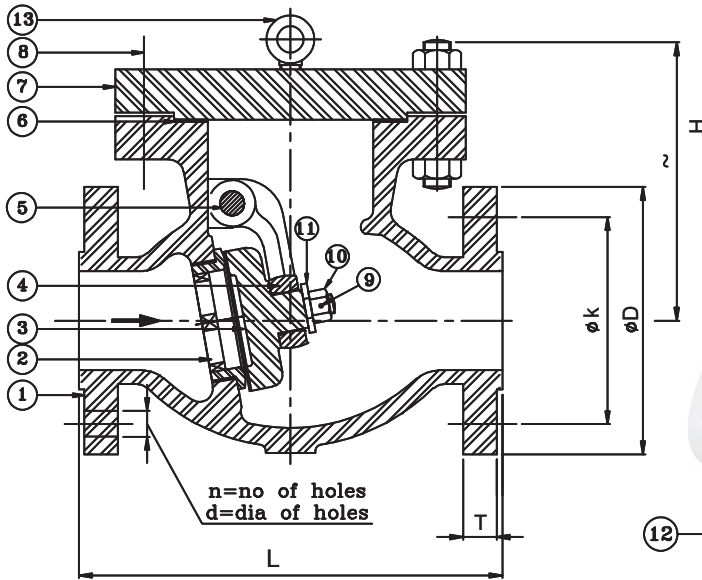

n=No. of holes
d=Dia. of holes

STANDARD MATERIAL COMBINATION

P. NO.	PART DESCRIPTION	Carbon steel to ASTM		Alloy steel to ASTM					Stainless steel to ASTM			
		Type WCB	Type LCB	Type WC1	Type WC6	Type WC9	Type C5	Type C12	Type CF8	Type CF8M	Type CF3	Type CF3M
1	BODY	A216 WCB	A352 LCB	A217 WC1	A217 WC6	A217 WC9	A217 C5	A217 C12	A351 CF8	A351 CF8M	A351 CF3	A351 CF3M
2	BODY SEAT RING	A216 WCB	A352 LCB	A217 WC1	A217 WC6	A217 WC9	A217 C5	A217 C12	A351 CF8	A351 CF8M	A351 CF3	A351 CF3M
3	DISC	AS PER TRIM MATERIAL COMBINATION										
4	HING	A216 WCB	A352 LCB	A217 WC1	A217 WC6	A217 WC9	A217 C5	A217 C12	A351 CF8	A351 CF8M	A351 CF3	A351 CF3M
6	GASKET	Stainless Steel + Graphoil										
7	BONNET	A216 WCB	A352 LCB	A217 WC1	A217 WC6	A217 WC9	A217 C5	A217 C12	A351 CF8	A351 CF8M	A351 CF3	A351 CF3M
8	STUD & NUT	A193 B7 A194 2H	A720 L7 A194 Gr4	A193 B16 A194 Gr4	A193 B16 A194 Gr4	A193 B16 A194 Gr4	A193 B16 A194 Gr4	A193 B16 A194 Gr4	A193 B8 A194 Gr8	A193 B8 A194 Gr8	A193 B8 A194 Gr8	A193 B8 A194 Gr8
10	DISC NUT	Stainless Steel										
12	SIDE PLUG	Stainless Steel										
13	LIFTING HOOK	Carbon Steel										

NOTE: The above data is subject to change without notice due to our continuing product improvement program.

TRIM MATERIAL COMBINATION (ON REQUEST)

Trim No.	Seat Ring Face	Wedge Seat Face	Stem	Backseat Bush	Lantern Ring
1	F6a/13%Cr.	F6a/13%Cr.	F6a/AISI410	F6a/AISI410	F6a/AISI410
2	F304	F304	F304/AISI304	F304/AISI304	F304/AISI304
5	STELLITE	STELLITE	F6a/AISI410	F6a/AISI410	F6a/AISI410
8	STELLITE	F6a/13%Cr.	F6a/AISI410	F6a/AISI410	F6a/AISI410
9	MONEL	MONEL	MONEL	MONEL	MONEL
10	F316	F316	F316/AIS1316	F316/AIS1316	F316/AIS1316
12	316+STELLITE	316	F316/AIS1316	F316/AIS1316	F316/AIS1316
13	ALLOY 20	ALLOY 20	ALLOY 20	ALLOY 20	ALLOY 20

NOTE: The above data is subject to change without notice due to our continuing product improvement program.

Valves can be supplied in other MOC's on request:-
SS (ASTM A 351 Gr.CF3MN / CF8C / CN7M), DSS (ASTM A 995 Gr.4A / 5A/ 3A/ 6A)



CAST STEEL SWING CHECK VALVES- BS 1868, API-6D

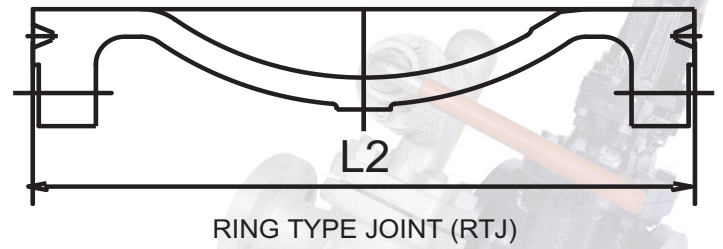
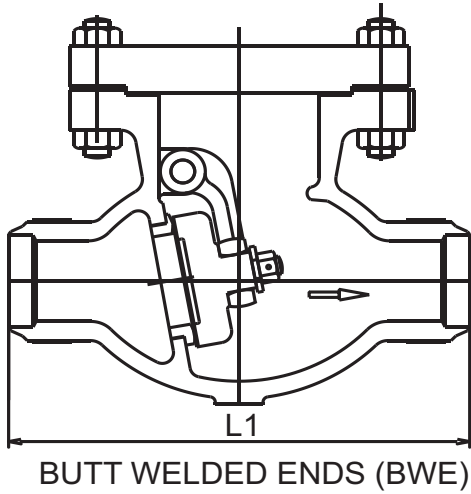

NOTE:

- (1) CLASS 150 & 300 FLANGES ARE FURNISHED WITH 2mm RAISED FACE
- (f) CLASS 600 & ABOVE FLANGES ARE FURNISHED WITH 7mm RAISED FACE (f) WHICH IS ADDITIONAL TO THE FLANGE THICKNESS (T)

All dimensions in mm

DIMENSIONAL DATA CLASS - 150

DN	40	50	65	80	100	125	150	200	250	300	350	400	450	500	600
NPS	1 ½	2	2 ½	3	4	5	6	8	10	12	14	16	18	20	24
L	165	203	216	241	292	330	356	495	622	698	787	864	978	978	1295
L1	165	203	216	241	292	330	356	495	622	698	787	864	978	978	1295
L2	178	216	229	254	305	343	369	508	635	711	800	877	991	991	1308
D	125	150	180	190	230	255	280	345	405	485	515	595	635	300	815
T	12.7	14.3	15.9	17.5	22.3	22.3	23.9	27	28.6	30.2	33.4	35	38.1	41.3	46.1
K(PCD)	98.4	121.7	139.7	152.4	190.5	215.9	241.3	298.5	362	431.8	476.2	539.8	577.8	635	749.3
n	04	04	04	04	08	08	08	08	12	12	12	16	16	20	20
d	15.9	19	19	19	19	22.2	22.2	22.2	25.4	25.4	28.6	28.6	31.8	31.8	34.9
H	130	140	165	168	190	228	230	261	345	356	425	468	540	600	680
b	38	51	64	76	102	127	152	203	254	300	337	387	438	489	591
Aprox.Wt.κ	12	17	27.1	34.5	56	76	93	159	277	580	487	715	905	986	1400

NOTE: Flanges as per ASME B16.5. Butt Weld Ends as per ANSI B 16.25.

The above data is subject to change without notice due to our continuing product improvement program. (▲WEIGHT GIVEN IN KGS)

TEST PRESSURES

CLASS	SHELL TEST (HYDROSTATIC)		SEAT TEST HYDROSTATIC	
150	30 Bar	435 Psi g	22 Bar	319 Psi g