

**CAST STEEL**

**ACCESSIBLE**

## **FEED CHECK VALVE**

**CHECK VALVE WITH BETTER ACCESSIBILITY WHILE THE BOILER IS IN OPERATION**

### **DESCRIPTION :**

'WJ' Cast Steel Accessible Feed Check Valve, Outside Screw, Yoke Type, Rising Spindle with 13% Cr. S.S. (AISI-410) Working Parts, Bolted Bonnet, Flanged Ends to BS-10 Table 'J'. Suitable for Max. 350 psig (24.6 Kg/Cm<sup>2</sup>g) Working Pressure and 425°C Temp. Tested to 700 psig (49.2 Kg/Cm<sup>2</sup>g) Hydraulic Pressure.

### **SALIENT FEATURES :**

1. Accessible feed check valve consists of two valves, a stop valve operated by a hand wheel and a back pressure check valve.
2. Available with Straight or curved inlet.
3. Accessibility of check valve can be examined while the boiler is in operation by closing the stop valve and removing the inlet.
4. 40mm, 50mm and 65mm size accessible feed check valves are also available with inspection branch.

### **TESTING AND CERTIFICATION :**

All valves are tested at double the max. working pressure. Each valve is supplied with IBR Test Certificate in Form III-C issued by The Director of Boilers, Punjab.



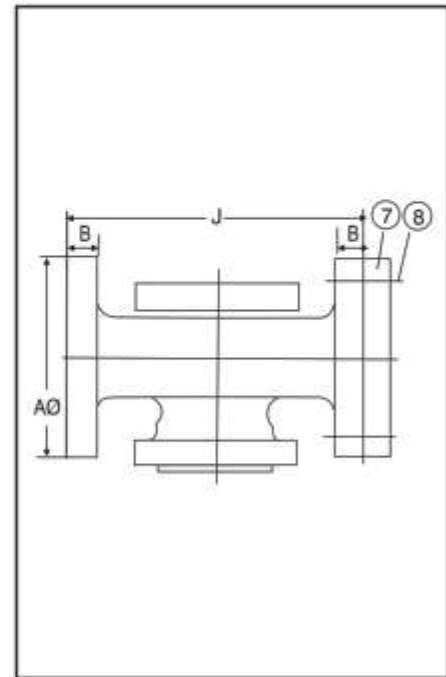
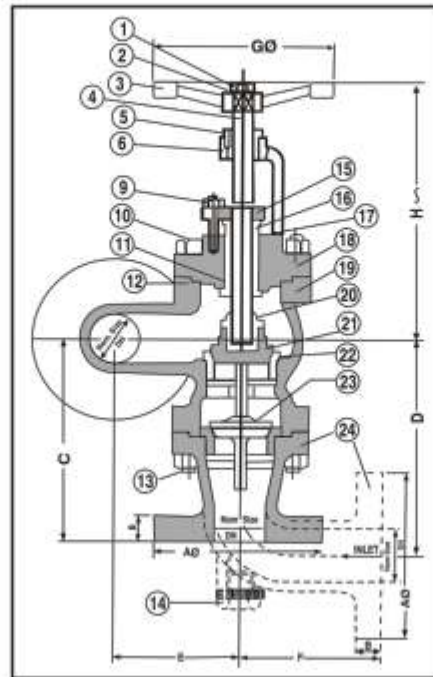
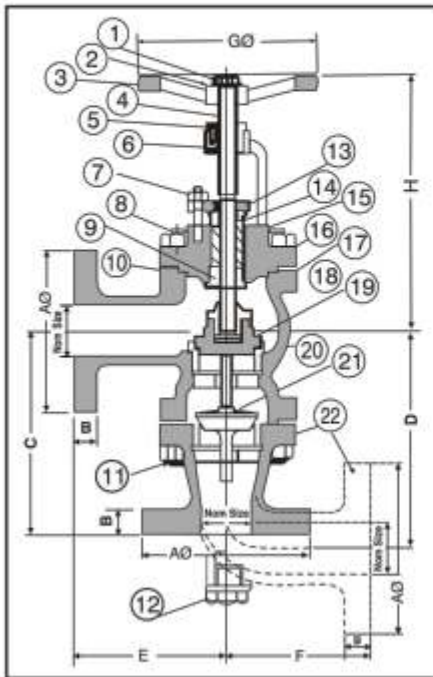

| DIMENSIONS<br>Without Inspection Branch |       |      |     |     |     |     |     |     |
|---|-------|------|-----|-----|-----|-----|-----|-----|
| Nominal Size                            | A     | B    | C   | D   | E   | F   | G   | H   |
| DN25 (1")                               | 121   | 19.1 | 135 | 135 | 100 | 100 | 150 | 190 |
| DN40 (1½")                              | 140   | 22.2 | 180 | 191 | 140 | 133 | 175 | 230 |
| DN50 (2")                               | 165   | 25.4 | 203 | 216 | 152 | 140 | 200 | 260 |
| DN65 (2½")                              | 184.2 | 25.4 | 238 | 238 | 178 | 165 | 250 | 300 |
| DN80 (3")                               | 203   | 32   | 264 | 264 | 203 | 165 | 250 | 320 |

| DIMENSIONS<br>With Inspection Branch |       |      |     |     |     |     |     |     |     |
|--------------------------------------|-------|------|-----|-----|-----|-----|-----|-----|-----|
| Nominal Size                         | A     | B    | C   | D   | E   | F   | G   | H   | J   |
| DN40 (1½")                           | 140   | 22.2 | 180 | 191 | 114 | 133 | 175 | 230 | 228 |
| DN50 (2")                            | 165   | 25.4 | 203 | 216 | 127 | 140 | 200 | 260 | 254 |
| DN65 (2½")                           | 184.2 | 25.4 | 238 | 238 | 140 | 165 | 250 | 300 | 280 |

| MATERIALS |                         |                    |                     |
|-----------|-------------------------|--------------------|---------------------|
| PART No.  | NAME OF PART            | MATERIAL           | SPECIFICATION       |
| 1.        | Nut for Hand Wheel      | M.S.               | ----                |
| 2.        | Washer                  | M.S.               | ----                |
| 3.        | Hand Wheel              | C.I.               | IS 210 FG 200       |
| 4.        | Stem                    | S.S.               | AISI-410            |
| 5.        | Locking Screw           | S.S.               | AISI-410            |
| 6.        | Bush                    | S.S.               | AISI-410            |
| 7.        | Studs & Nuts for Gland  | Carbon Steel       | ----                |
| 8.        | Studs & Nuts            | Carbon Steel       | ----                |
| 9.        | Back Seat Bush          | S.S.               | AISI-410            |
| 10.       | Gasket                  | Steam Jointing     | ----                |
| 11.       | Studs & Nuts            | Carbon Steel       | ----                |
| 12.       | Drain Plug              | Bronze             | IBR 282(a)(iv)Gr. B |
| 13.       | Gland Flange            | Cast Steel         | IBR 73 to 80        |
| 14.       | Gland                   | S.S.               | AISI-410            |
| 15.       | Packing                 | Graphited Asbestos | ----                |
| 16.       | Bonnet                  | Cast Steel         | IBR 73 to 80        |
| 17.       | Body                    | Cast Steel         | IBR 73 to 80        |
| 18.       | Disc Nut                | S.S.               | AISI-410            |
| 19.       | Disc                    | S.S.               | AISI-410            |
| 20.       | Body Seat Ring          | S.S.               | AISI-410            |
| 21.       | Check Valve Disc        | S.S.               | AISI-410            |
| 22.       | Straight / Curved Inlet | Cast Steel         | IBR 73 to 80        |