

SKS VALVES are backed by years of accumulated & all round experience, combined with the use State-of-the Art Materials & Production Resources. "SKS" - Products are carefully planned at every stage of Concept, Design & Construction. The Quality Integration from the Raw Material up to the Stage of Final Product Guarantees the "SKS" - Valve Quality.

All "SKS" - Valves OUT-PERFORM any of our competitor's owing to Better Design & Technical Features.

SKS 501

Forged Brass Ball Valve PN 25

UNIQUE FEATURES

- ✓ Forged Brass Nickel Plated Body
- ✓ Full Bore
- ✓ CW617N Grade Brass (Low Lead)
- ✓ PTFE Seats
- ✓ Self Locking Nyloc Nut
- ✓ PN25 Rating
- ✓ Screwed BSP (F) Thread

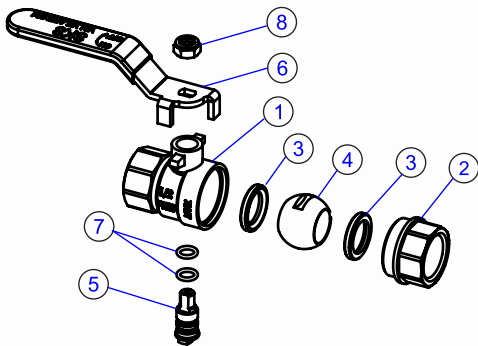

1/4" - 1/2" Assembly drawing

No.	Name	Material	Qty.
1	Body	Forged Brass CW617N	1
2	Bonnet	Forged Brass CW617N	1
3	Seat	PTFE	2
4	Ball	Forged Brass	1
5	Stem	Forged Brass	1
6	Handle	Steel Q235 with blue zinc plating with PVC RAL 5002	1
7	O-ring	EPDM with WRAS approved	2
8	Hex Nut	Steel Q235 Lock Nylon Nut	1

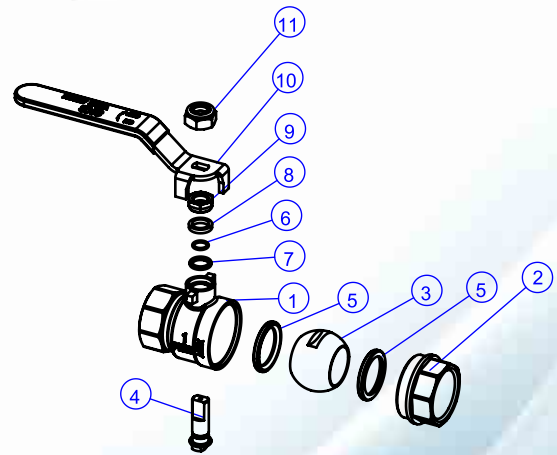

3/4" - 2" Assembly drawing

No.	Name	Material	Qty.
1	Body	Forged Brass CW617N	1
2	Bonnet	Forged Brass CW617N	1
3	Ball	Forged Brass	1
4	Stem	Forged Brass	1
5	Seat	PTFE	2
6	O-ring	EPDM with WRAS approved	2
7	Seat	PTFE	1
8	Seat	PTFE	1
9	Packing Nut	Forged Brass	1
10	Handle	Steel Q235 with blue zinc plating with PVC RAL 5002	1
11	Hex Nut	Steel Q235 Lock Nylon Nut	1